

雲海 Unkai Tearoom

Unkai is a tearoom built in the sukuiya style, rich with the traditional beauty of Japanese architecture and fragrant with the relaxing scent of wood. From tea ceremonies and flower arranging to Japanese poetry, this space is used to pass on Japanese culture to modern generations.



The hiroma (grand room) as seen from the yorituki (antechamber), showcasing the spacious connecting rooms.



Steppingstones leading from the grand room's garden to the veranda and covered passageway.



The hirikawa (covered passageway), looking out onto the green of the garden, and bathed in natural light.

Tea Room Layout

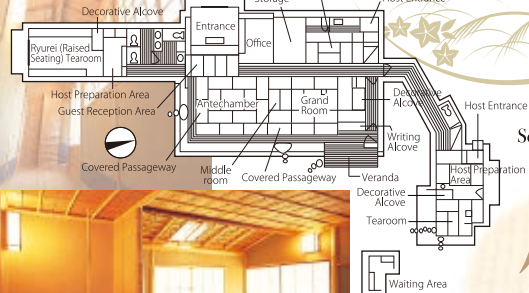

静月庵

Seigetsu-an is a small tearoom, five and a half tatami mats in size. It has the timeless aura of a rustic thatched teahouse. Step out of the ordinary and enjoy an authentic Japanese tea ceremony, as your host diligently attends to you.



The roji (entrance garden) as glimpsed through the open guest entrances. The nijiri-guchi on the left is entered by crawling, while the kinin-guchi on the right is entered standing up.



The rustic Seigetsu-an Tearoom, as seen from the roji (entrance garden).

To use or tour the tearoom, please call the management office at 054-251-0016.

*Use requires an advance reservation and costs a fee.
Use may be refused depending on the desired purpose.

*Tours may not always be possible depending on usage status at the time.

Suruga in Miniature, Beyond Time & Teeming with Tradition.

Experience the Ambience of Suruga Province and the Changing Seasons of Japan in this Traditional Garden.

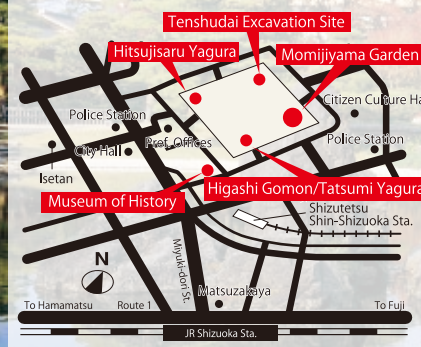

Visitor Information

Open Hours: 9:00 am to 4:30 pm (Admission until 4:00 pm)

Closed: Mondays (excl. public holidays) and New Year's holidays (Dec 29-Jan 3)

Admission: Adults 150 JPY (120 JPY for groups of 20 or more), Elem. and Jr. H. School Students 50 JPY (40 JPY for groups of 20 or more)

*Free admission for residents of Shizuoka City aged 70 and older. Combined Ticket for Momijiyama Garden, Higashi Gomon, Tatsumi Yagura and Hitsujiyaru Yagura:

Adults 360 JPY (280 JPY for groups of 20 or more), Elem. and Jr. H. School Students 120 JPY (90 JPY for groups of 20 or more)

Getting Here

Approx. 15min walk from JR Shizuoka Sta.

Approx. 12min walk from Shin-Shizuoka Sta. on the Shizutetsu Line
Approx. 17min by car from Shizuoka Interchange on the Tomei Expressway

Approx. 18min by car from Shin-Shizuoka Interchange on the Shin-Tomei Expressway

Inquiries

Sumpu Castle Park Ninomaru Facilities Management Office
1-1 Sumpujo-koen, Aoi-ku, Shizuoka-shi 420-0855
Tel: 054-251-0016 / Fax: 054-251-0056

Designated Administrator

Sumpu Castle Park Landmark Joint Project Entity



Sumpu Castle Park Homepage



Instagram



facebook

Momijiyama Japanese Garden
in Sumpu Castle Park

駿府城公園 紅葉山庭園

<https://www.sumpu-castlepark.com>