

雲海 Unkai Tearoom

Unkai is a tearoom built in the sukiya style, rich with the traditional beauty of Japanese architecture. This space, fragrant with the relaxing scent of wood, can be used for a variety of purposes: tea ceremony, flower arrangement, haiku and more, bringing traditional Japanese culture to the future.



A spacious connecting room affording a view of the large room from the antechamber



Stepping stones leading from the large room's garden to the cloister



The cloister, looking onto garden greenery and filled with natural sunlight

Tea Room Layout

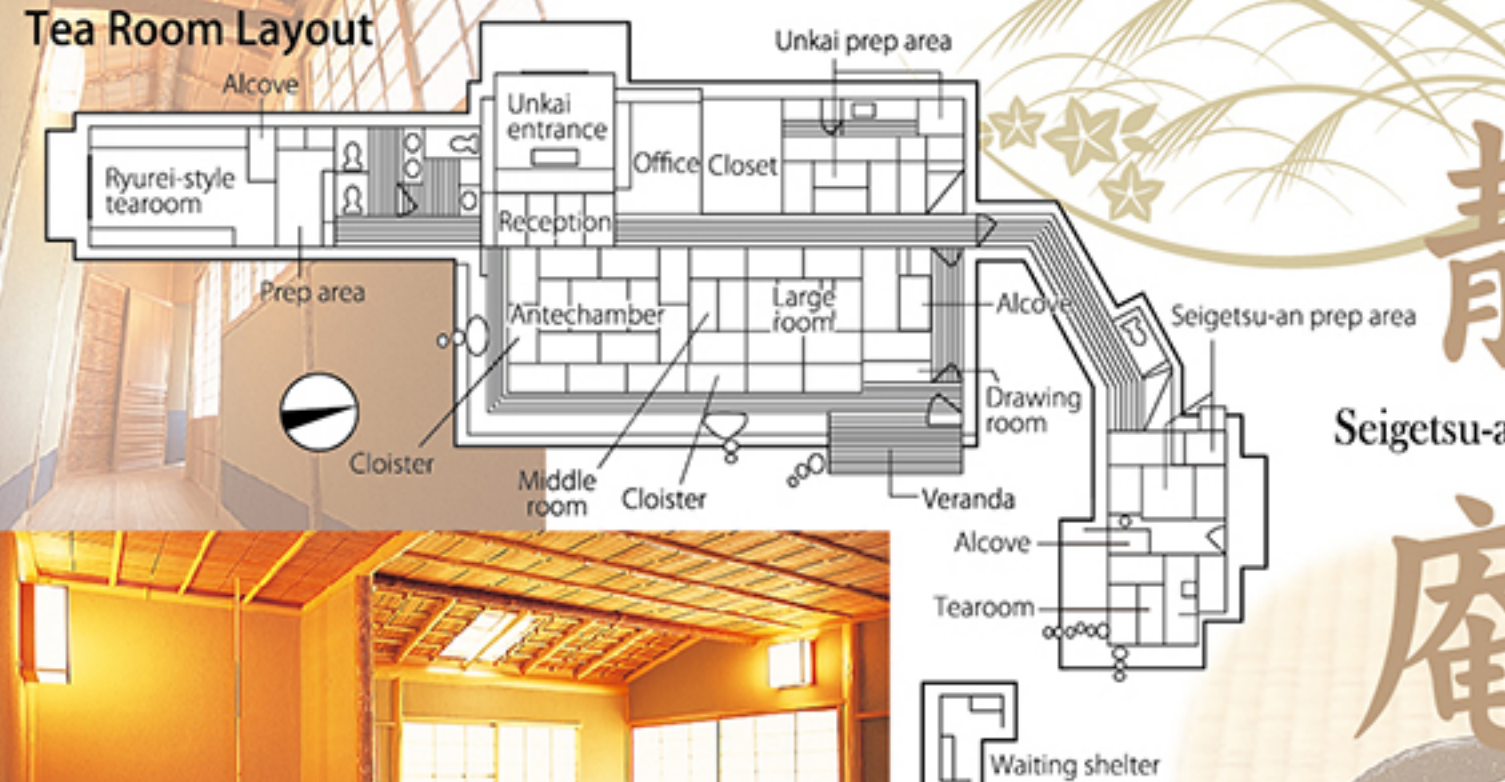

静月庵 Seigetsu-an

Seigetsu-an is a small tearoom, 5 1/2 tatami mats in size. It has the serene, timeless aura of a tea hut. Step out of the ordinary and enjoy authentic Japanese tatamae as the host attends to his/her guests.



Seigetsu-an's aura seen from the stepping stones



Stepping stones glimpsed from the small door leading into the tearoom

To use or tour the tea room, please call the management office at 054-251-0016.

*Use requires an advance reservation and costs a fee. Use may be refused depending on purpose.

*Tours may not be possible depending on circumstances.

Suruga in Miniature, Beyond Time & Teeming with Tradition.

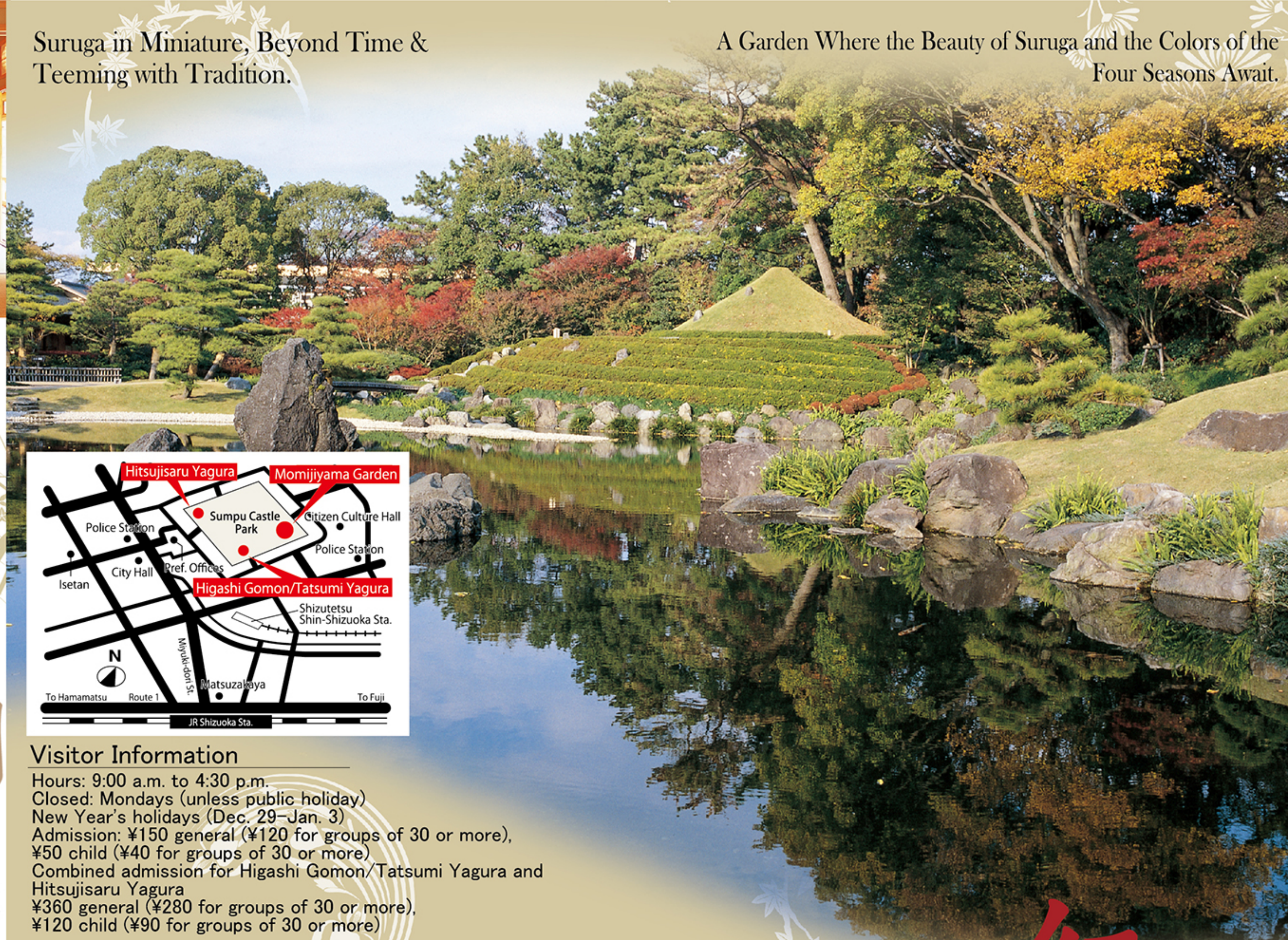

A Garden Where the Beauty of Suruga and the Colors of the Four Seasons Await.

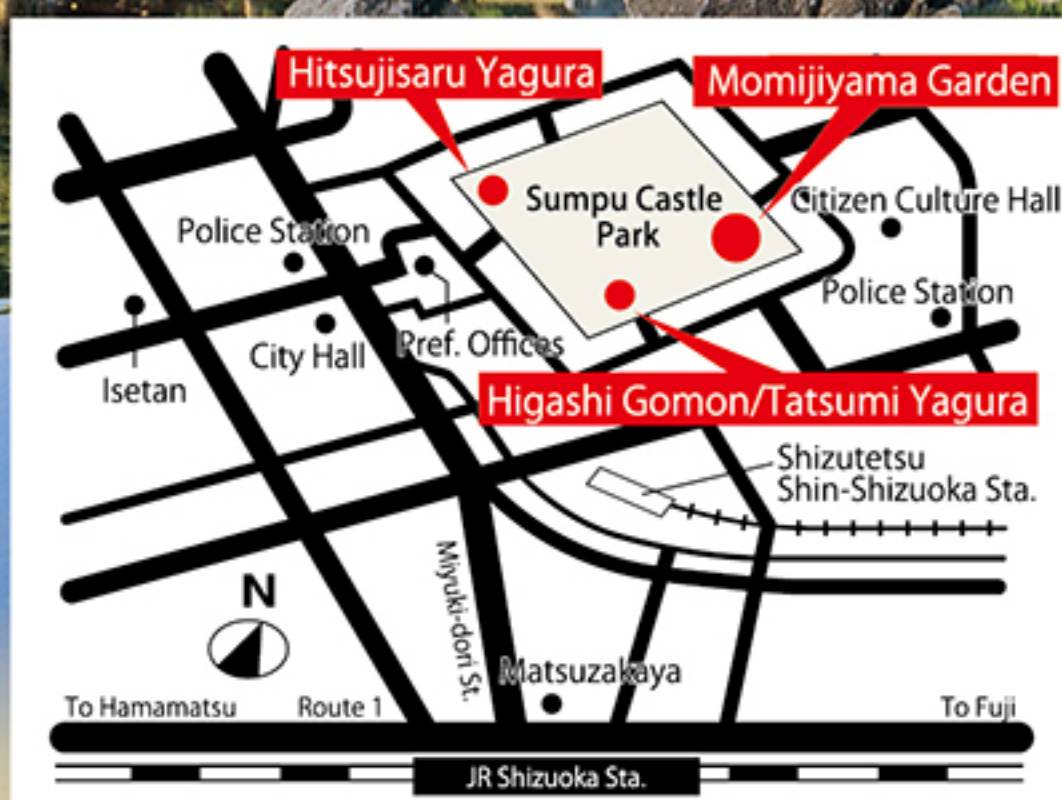

Visitor Information

Hours: 9:00 a.m. to 4:30 p.m.

Closed: Mondays (unless public holiday)

New Year's holidays (Dec. 29-Jan. 3)

Admission: ¥150 general (¥120 for groups of 30 or more),

¥50 child (¥40 for groups of 30 or more)

Combined admission for Higashi Gomon/Tatsumi Yagura and Hitsujiyaru Yagura

¥360 general (¥280 for groups of 30 or more),

¥120 child (¥90 for groups of 30 or more)

Getting Here

Approx. 15min walk from JR Shizuoka Sta.

Approx. 12min walk from Shin-Shizuoka Sta. on the Shizutetsu Line

Approx. 17min by car from Shizuoka Interchange on the Tomei Expressway

Approx. 18min by car from Shin-Shizuoka Interchange on the Shin-Tomei Expressway

Inquiries

Sumpu Castle Park Ninomaru Facilities Management Office

1-1 Sumpu-koen, Aoi-ku, Shizuoka-shi 420-0855

Tel: 054-251-0016 / Fax: 054-251-0056

Designated Administrator

Sumpu Castle Park Tourism & Culture

Facilities Management/Operations Joint

Project Entity

<http://www.sumpu-castlepark.com>



Sumpu Castle Park Homepage

駿府城公園 紅葉山庭園
Momijiyama Japanese Garden
in Sumpu Castle Park

紅葉山庭園
もみじやま